

# Methods of Joining

**Bold Type** Designates a Stock Item      Order by Product ID Number

## Standard Part A Adapter X Female NPT Thread

OD	MATERIAL	WEIGHT	PRODUCT ID
1-1/2"	Aluminum	0.25	A150FAL
1-1/2"	Stainless Steel	0.81	A150FSS
<b>2"</b>	<b>Aluminum</b>	<b>0.37</b>	<b>A200FAL</b>
2"	Stainless Steel	1.06	A200FSS
<b>2-1/2"</b>	<b>Aluminum</b>	<b>0.56</b>	<b>A250FAL</b>
2-1/2"	Stainless Steel	1.56	A250FSS
<b>3"</b>	<b>Aluminum</b>	<b>0.75</b>	<b>A300FAL</b>
3"	Stainless Steel	2.0	A300FSS
<b>4"</b>	<b>Aluminum</b>	<b>1.56</b>	<b>A400FAL</b>
4"	Stainless Steel	4.12	A400FSS
5"	Aluminum	1.81	A500FAL
6"	Aluminum	2.44	A600FAL

## Standard Part C Coupler X Hose Shank

OD	MATERIAL	WEIGHT	PRODUCT ID
<b>1-1/2"</b>	<b>Aluminum</b>	<b>0.78</b>	<b>C150FAL</b>
1-1/2"	Stainless Steel	1.84	C150FSS
<b>2"</b>	<b>Aluminum</b>	<b>1.16</b>	<b>C200FAL</b>
2"	Stainless Steel	2.31	C200FSS
<b>2-1/2"</b>	<b>Aluminum</b>	<b>1.56</b>	<b>C250FAL</b>
2-1/2"	Stainless Steel	3.12	C250FSS
<b>3"</b>	<b>Aluminum</b>	<b>2</b>	<b>C300FAL</b>
3"	Stainless Steel	4.87	C300FSS
<b>4"</b>	<b>Aluminum</b>	<b>3.37</b>	<b>C400FAL</b>
4"	Stainless Steel	8.25	C400FSS
5"	Aluminum	4.19	C500FAL
6"	Aluminum	6.06	C600FAL

## Standard Part B Coupler X Male NPT Thread

OD	MATERIAL	WEIGHT	PRODUCT ID
1-1/2"	Aluminum	0.75	B150FAL
1-1/2"	Stainless Steel	1.56	B150FSS
2"	Aluminum	0.94	B200FAL
2"	Stainless Steel	2.06	B200FSS
2-1/2"	Aluminum	1.25	B250FAL
2-1/2"	Stainless Steel	2.94	B250FSS
3"	Aluminum	1.75	B300FAL
3"	Stainless Steel	4	B300FSS
4"	Aluminum	2.5	B400FAL
4"	Stainless Steel	6.5	B400FSS
5"	Aluminum	3.75	B500FAL
6"	Aluminum	5.37	B600FAL

## Standard Part D Coupler X Female NPT Thread

OD	MATERIAL	WEIGHT	PRODUCT ID
1-1/2"	Aluminum	0.84	D150FAL
1-1/2"	Stainless Steel	1.81	D150FSS
2"	Aluminum	1	D200FAL
2"	Stainless Steel	2.37	D200FSS
2-1/2"	Aluminum	1.41	D250FAL
2-1/2"	Stainless Steel	3.16	D250FSS
3"	Aluminum	1.78	D300FAL
3"	Stainless Steel	4.09	D300FSS
4"	Aluminum	2.81	D400FAL
4"	Stainless Steel	7	D400FSS
5"	Aluminum	4.37	D500FAL
6"	Aluminum	6	D600FAL

### Adapter & Coupler Specifications

- 1-1/2" through 6"
- Aluminum & Stainless
- 8" available upon request

**Security chains available**

**Other sizes and materials available. Please Call!**

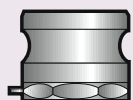

**Part A - Adapter X Female NPT Thread**

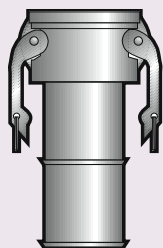

**Part C - Coupler X Hose Shank**

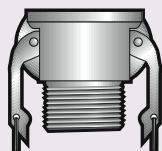

**Part B - Coupler X Male NPT Thread**

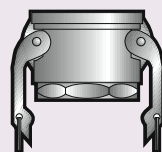

**Part D - Coupler X Female NPT Thread**

### SPECIAL SERVICES

- Shot Peening
- Spiral Grooving
- Porcelain Lining
- Ceramic Coating
- Part Variations



**Bold Type** Designates a Stock Item

Order by Product ID Number

## Standard Part E Adapter X Hose Shank

OD	MATERIAL	WEIGHT	PRODUCT ID
<b>1-1/2"</b>	<b>Aluminum</b>	<b>0.37</b>	<b>E150FAL</b>
1-1/2"	Stainless Steel	1.65	E150FSS
<b>2"</b>	<b>Aluminum</b>	<b>0.84</b>	<b>E200FAL</b>
2"	Stainless Steel	2.75	E200FSS
<b>2-1/2"</b>	<b>Aluminum</b>	<b>0.91</b>	<b>E250FAL</b>
2-1/2"	Stainless Steel	3.5	E250FSS
<b>3"</b>	<b>Aluminum</b>	<b>1.47</b>	<b>E300FAL</b>
3"	Stainless Steel	4.06	E300FSS
<b>4"</b>	<b>Aluminum</b>	<b>2.5</b>	<b>E400FAL</b>
4"	Stainless Steel	7.81	E400FSS
5"	Aluminum	2.69	E500FAL
6"	Aluminum	4.56	E600FAL

## Standard Part V Coupler Dust Cap

OD	MATERIAL	WEIGHT	PRODUCT ID
<b>1-1/2"</b>	<b>Aluminum</b>	<b>0.81</b>	<b>V150FAL</b>
1-1/2"	Stainless Steel	1.5	V150FSS
<b>2"</b>	<b>Aluminum</b>	<b>0.94</b>	<b>V200FAL</b>
2"	Stainless Steel	2.06	V200FSS
<b>2-1/2"</b>	<b>Aluminum</b>	<b>1.19</b>	<b>V250FAL</b>
2-1/2"	Stainless Steel	2.84	V250FSS
<b>3"</b>	<b>Aluminum</b>	<b>1.78</b>	<b>V300FAL</b>
3"	Stainless Steel	3.75	V300FSS
<b>4"</b>	<b>Aluminum</b>	<b>2.5</b>	<b>V400FAL</b>
4"	Stainless Steel	5.31	V400FSS
5"	Aluminum	3.19	V500FAL
6"	Aluminum	5.19	V600FAL

## Standard Part F Adapter X Male NPT Thread

OD	MATERIAL	WEIGHT	PRODUCT ID
1-1/2"	Aluminum	0.5	F150FAL
1-1/2"	Stainless Steel	1.28	F150FSS
2"	Aluminum	0.53	F200FAL
2"	Stainless Steel	1.75	F200FSS
2-1/2"	Aluminum	0.81	F250FAL
2-1/2"	Stainless Steel	3.25	F250FSS
3"	Aluminum	1.37	F300FAL
3"	Stainless Steel	4.5	F300FSS
4"	Aluminum	2.28	F400FAL
4"	Stainless Steel	7	F400FSS
5"	Aluminum	2.72	F500FAL
6"	Aluminum	4.31	F600FAL

## Standard Part W Adapter Dust Plug

OD	MATERIAL	WEIGHT	PRODUCT ID
1-1/2"	Aluminum	0.22	W150FAL
1-1/2"	Stainless Steel	1	W150FSS
<b>2"</b>	<b>Aluminum</b>	<b>0.34</b>	<b>W200FAL</b>
2"	Stainless Steel	1.44	W200FSS
<b>2-1/2"</b>	<b>Aluminum</b>	<b>0.44</b>	<b>W250FAL</b>
2-1/2"	Stainless Steel	2	W250FSS
<b>3"</b>	<b>Aluminum</b>	<b>0.87</b>	<b>W300FAL</b>
3"	Stainless Steel	2.62	W300FSS
<b>4"</b>	<b>Aluminum</b>	<b>1.37</b>	<b>W400FAL</b>
4"	Stainless Steel	5.25	W400FSS
5"	Aluminum	1.5	W500FAL
6"	Aluminum	2.31	W600FAL

## Adapter & Coupler Specifications

- 1-1/2" through 6"
  - Aluminum & Stainless
- Security chains available**
- Other sizes and materials available. Please Call!**

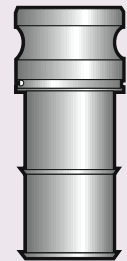

**Part E - Adapter X  
Hose Shank**

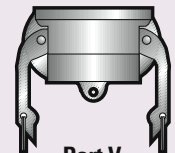

**Part V  
Coupler Dust Cap**

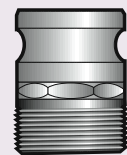

**Part F - Adapter X  
Male NPT Thread**

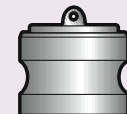

**Part W  
Adapter Dust Plug**

### Why Buy Our Cam & Groove Parts?

- Pressure tested with published ratings
  - Will handle full vacuum applications
  - **All sizes, except 5" & 8" comply with MIL Spec A-A-59326**
- Compliance to this specification allows industry interchangeability

**Please Call For Pricing & Information!**

### TERMINOLOGY

- CLR** = Center Line Radius
- ERW** = Electric Welded Resistance
- FNPT** = Female National Pipe Thread
- ID** = Inside Diameter
- MNPT** = Male National Pipe Thread
- NPS** = Nominal Pipe Size
- OD** = Outside Diameter
- SCH** = Schedule

All reference dimensions are nominal.

# Methods of Joining

## Compression Nut Quick Adapters & Couplers

- Designed for quick assembly, with a compression nut, to 1-1/2" to 3" tubing.
- Aluminum with Buna Gasket



Part FC Adapter

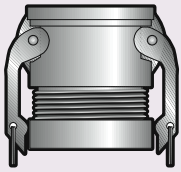

Part BC Coupler

### SPECIAL SERVICES

- Shot Peening
- Spiral Grooving
- Porcelain Lining
- Ceramic Coating
- Part Variations



**Bold Type** Designates a Stock Item

Order by Product ID Number

## Part BC - Compression Nut Quick Couplers Coupler X Tubing Fitting

OD	MATERIAL	PRODUCT ID
1-1/2"	Aluminum	<b>BC150AL</b>
2"	Aluminum	<b>BC200AL</b>
2-1/2"	Aluminum	<b>BC250AL</b>
3"	Aluminum	<b>BC300AL</b>

## Part FC - Compression Nut Quick Adapters Adapter X Tubing Fitting

OD	MATERIAL	PRODUCT ID
1-1/2"	Aluminum	<b>FC150AL</b>
2"	Aluminum	<b>FC200AL</b>
2-1/2"	Aluminum	<b>FC250AL</b>
3"	Aluminum	<b>FC300AL</b>

## Security Chains

Brass Chain With Hooks or Rings  
For Standard Cam & Groove

OD	MATERIAL	CHAIN ENDS	PRODUCT ID
6"	0.25	Hook	<b>BRCHAIN6H</b>
6"	0.25	Ring	BRCHAIN6R
12"	0.5	Hook	<b>BRCHAIN12H</b>
12"	0.5	Ring	<b>BRCHAIN12R</b>

### Why Buy Our Cam & Groove Parts?

- Pressure tested with published ratings
- Will handle full vacuum applications
- **All sizes, except 5" & 8" comply with MIL Spec A-A-59326**  
Compliance to this specification allows industry interchangeability

Please Call For Pricing & Information!

**Bold Type** Designates a Stock Item    *Order by Product ID Number*

## Tube Quick Adapters

OD	GAUGE	PRODUCT ID
2"	<b>16</b>	<b>AWS200AL-16A</b>
2"	14	AWS200AL-14A
2"	11	AWS200AL-11A
<b>2-1/2"</b>	<b>16</b>	<b>AWS250AL-16A</b>
2-1/2"	14	AWS250AL-14A
2-1/2"	11	AWS250AL-11A
<b>3"</b>	<b>16</b>	<b>AWS300AL-16A</b>
3"	14	AWS300AL-14A
3"	11	AWS300AL-11A
<b>4"</b>	<b>16</b>	<b>AWS400AL-16A</b>
4"	14	AWS400AL-14A
4"	11	AWS400AL-11A
5"	14	AWS500AL-14A
5"	11	AWS500AL-11A
6"	14	AWS600AL-14A
6"	11	AWS600AL-11A

## Tube Quick Couplers

OD	GAUGE	PRODUCT ID
2"	<b>16</b>	<b>DWS200AL-16A</b>
2"	14	DWS200AL-14A
2"	11	DWS200AL-11A
<b>2-1/2"</b>	<b>16</b>	<b>DWS250AL-16A</b>
2-1/2"	14	DWS250AL-14A
2-1/2"	11	DWS250AL-11A
<b>3"</b>	<b>16</b>	<b>DWS300AL-16A</b>
3"	14	DWS300AL-14A
3"	11	DWS300AL-11A
<b>4"</b>	<b>16</b>	<b>DWS400AL-16A</b>
4"	14	DWS400AL-14A
4"	11	DWS400AL-11A
5"	14	DWS500AL-14A
5"	11	DWS500AL-11A
6"	14	DWS600AL-14A
6"	11	DWS600AL-11A

## Specifications

Our Quick Adapter (AWS) and Coupler (DWS) are welded to a short length of tube or pipe for easy installation or dismantling.

- 2" through 6" OD, 16, 14, 11 Gauge Stubs
- 2" through 6" NPS, Schedule 10, 40 Stubs (SCH 5 available)
- Aluminum

**Security chains available**

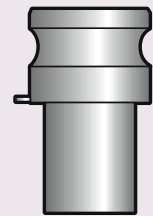

Part AWS Adapter

## Pipe Quick Adapters

OD	SCHEDULE	PRODUCT ID
2"	10	AWSP200AL-10A
2"	40	AWSP200AL-40A
3"	10	AWSP300AL-10A
3"	40	AWSP300AL-40A
4"	10	AWSP400AL-10A
4"	40	AWSP400AL-40A
5"	10	AWSP500AL-10A
5"	40	AWSP500AL-40A
6"	10	AWSP600AL-10A
6"	40	AWSP600AL-40A

## Pipe Quick Couplers

OD	SCHEDULE	PRODUCT ID
2"	10	DWSP200AL-10A
2"	40	DWSP200AL-40A
3"	10	DWSP300AL-10A
3"	40	DWSP300AL-40A
4"	10	DWSP400AL-10A
4"	40	DWSP400AL-40A
5"	10	DWSP500AL-10A
5"	40	DWSP500AL-40A
6"	10	DWSP600AL-10A
6"	40	DWSP600AL-40A

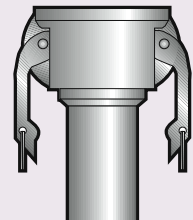

Part DWS Coupler

### TERMINOLOGY

**CLR** = Center Line Radius  
**ERW** = Electric Welded Resistance  
**FNPT** = Female National Pipe Thread  
**ID** = Inside Diameter  
**MNPT** = Male National Pipe Thread  
**NPS** = Nominal Pipe Size  
**OD** = Outside Diameter  
**SCH** = Schedule

*All reference dimensions are nominal.*